

ZIRCU

زركو للصناعات البلاستيكية

ZIRCU Plastic Industries

أول مصنع فى العالم
لإنتاج الوصلات
حتى مقاس ٦٣٠ مم للضغط العالى



The background of the entire page is a close-up photograph of numerous white UPVC pipes of various diameters, arranged in a way that creates a sense of depth and repetition. The pipes are stacked and oriented in different directions, with some showing their open ends. The lighting is dramatic, highlighting the smooth texture of the plastic and creating strong shadows.

ZIRCU

PLASTIC INDUSTRIES

UPVC Pipes & Fittings

The First factory in the world produce UPVC pressure fittings by injection molding up to 630 mm

Z I R C U P L A S T I C I N D U S T R I E S
www.zircuegypt.com



The First Leading plastic factory in the world that product UPVC preessure fittings by injection molding up to 630 mm .



Certificate

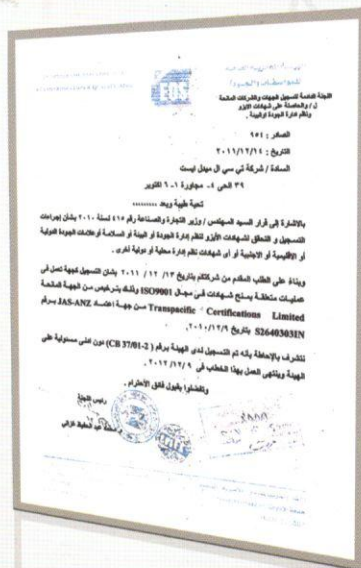
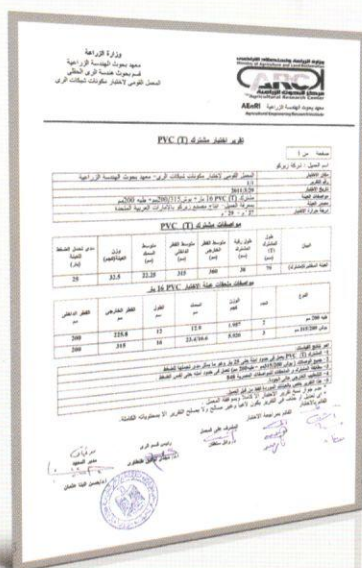

INTRODUCTION

ZIRCU plastic industries is a group of plastic factories located in Al Ain city - United Arab Emirates and at El Nobaria industrial city Egypt with a surface area of more than 116,600 sq.m, and more than 250 employees including technical and administration staffs and more than 1500 Product.

Being an ISO 9001:2000 certified company, Zircu plastic industries is committed to continual improvement of their products and services to cover all needs of construction and agriculture contractor with full range of products of high quality control and assurance which comply with national and international standards. Zircu plastic industries use the most advanced , sophisticated , and up to date plastic machines and facilities in order to meet with our esteemed customer's needs and satisfaction. For that we have established long term agreements with local laboratories of excellent national and international reputation in the field of quality control of plastic products in order to meet our commitments for high quality control, continuous products improvement.

Zircu plastic industries have a wide range of products which covers all needs of construction, agricultural and everyday life requirements.

Zircu plastic products include : PVC pipes and fittings of sizes range from 20mm up to 630mm O.D. Irrigation PE pipes and fittings, PP-R pipes and fittings, and heavy duty construction and agriculture PE sheets.

This is in addition to various household items, and plastic crates of different sizes and shapes used for packing of vegetables, fruits, chickens.....etc

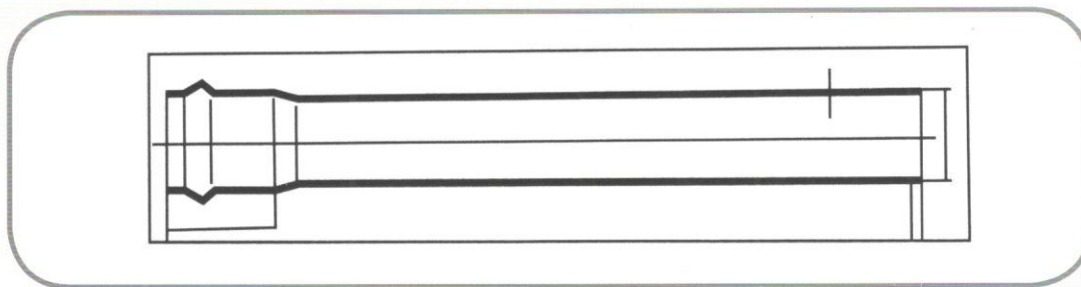

UPVC Pressure Pipes Specification In Accordance To DIN 8062

O.D.	Series 2 PN 4		Series 3 PN 6		Series 4 PN 10		Series 5 PN 16	
	S	Kg/m	S	Kg/m	S	Kg/m	S	Kg/m
20	-	-	-	-	-	-	1.5	0.137
25	-	-	-	-	1.5	0.174	1.9	0.221
32	-	-	-	-	1.8	0.264	2.4	0.342
40	-	-	1.8	0.334	1.9	0.35	3.0	0.525
50	-	-	1.8	0.422	2.4	0.552	3.7	0.809
63	-	-	1.9	0.562	3.0	0.854	4.7	1.29
75	1.8	0.642	2.2	0.782	3.6	1.22	5.6	1.82
90	1.8	0.774	2.7	1.13	4.3	1.75	6.7	2.61
110	2.2	1.16	3.2	1.64	5.3	2.61	8.2	3.90
125	2.5	1.48	3.7	2.13	6.0	3.34	9.3	5.01
140	2.8	1.84	4.1	2.65	6.7	4.18	10.4	6.27
160	3.2	2.41	4.7	3.44	7.7	5.47	11.9	8.17
180	3.6	3.02	5.3	4.37	7.6	6.88	13.4	10.4
200	4.0	3.7	5.9	5.37	9.6	8.51	14.9	12.8
225	4.5	4.7	6.6	6.67	10.8	10.8	16.7	16.1
250	4.9	5.65	7.3	8.31	11.9	13.2	18.6	19.9
280	5.5	7.11	8.2	10.4	13.4	16.6	20.8	24.9
315	6.2	9.0	9.2	13.2	15.0	20.9	23.4	31.5
400	7.9	14.5	11.7	21.1	19.1	33.7	29.7	50.8
450	8.9	18.3	13.2	26.8	21.5	42.7	-	-
500	9.8	22.4	14.6	32.9	23.9	52.6	-	-
630	12.4	35.7	18.4	52.2	30.0	83.2	-	-

N.B: the above valuse are given for a temperature of 20 O.D. Stands for outside Diameter,

S: wall thickness (mm), PN: pressure rating.

Zircu uPVC pipes can be produced with plain ends, Solvent Welded (S/W), and Rubber Ring (R/R) sockets. The standard length of the pipes is 6 in unless otherwise required by the customer.

UPVC PIPES SPECIFICATIONS IN ACCORDANCE TO ISO 161/1

O.D. (MM)	PN 6 (6.3)	PN 10	PN 16
	W/T	W/T	W/T
20	-	-	1.2
25	-	-	1.5
32	-	-	1.9
40	-	1.6	2.4
50	1.3	2.0	3.0
63	1.6	2.5	3.8
75	1.9	2.9	4.5
90	2.2	3.5	5.4
110	2.7	4.2	6.6
125	3.1	4.8	7.4
160	4.0	6.2	9.5
200	4.9	7.7	11.9
225	5.5	8.6	13.4
250	6.2	9.6	14.8
280	6.9	10.7	16.6
315	7.7	12.1	18.7
400	9.8	15.3	23.7

**UPVC SOIL AND WASTE PIPES,
In accordance to BS EN 1329 - UPVC**

Nominal Size	Outside Diameter		Maximum Wall Thickness
	Min	Max	
in	mm	mm	mm
1 1/4" / 32	36.15	36.45	2.2
1 1/2" / 40	42.75	43.05	2.3
2" / 50	55.75	56.05	2.4

A range of pipes intended to convey normal domestic waste.
Standard Length: 4 metres
Colour available: grey

**UPVC PIPES SOIL VENTILATING PIPES,
In accordance to BS 4514 : 2001**

Nominal mm	Mean outside diameter		Extreme outside diameter		Minimum wall thickness
	Min	Max	Min	Max	Min
mm	mm	mm	mm	mm	min
82.0	82.4	82.8	81.0	84.3	3.0

Standard Length : 6 metres
Colour available : grey

**UPVC PIPE DUCT PIPE For Electrical And
Telephone Cables**

Duct No.	Outside Diameter	Wall Thickness	
		Min	Max
	mm	mm	mm
54 - D	96.5	3.25	3.65
56 - D	53.9	1.55	1.70
57 - D	114.3	3.40	3.80

Standard Length : 6 metres
Colour Available : Black

UPVC PRESSURE PIPE
In accordance to ANSI/ ASTM D 1785 - 89 Schedule 40 - 80

Nominal Size	Nominal Size		Schedule 40 Wall thickness		Schedule 80 Wall thickness	
	Min	Max	Min	Max	Min	Max
in	Mm	Mm	Mm	Mm	Mm	Mm
1/2"	21.24	21.44	2.77	3.28	3.73	4.24
3/4"	26.57	26.77	2.87	3.38	3.91	4.42
1"	33.27	33.53	3.38	3.89	4.55	5.08
1 1/4"	42.03	42.29	3.56	4.06	4.85	5.44
1 1/2"	48.11	48.41	3.68	4.19	5.08	5.69
2"	60.17	60.47	3.91	4.24	5.54	6.20
2 1/2"	72.84	73.20	5.16	5.77	7.01	7.85
3"	88.70	89.10	5.49	6.15	7.62	8.53
3 1/2"	101.40	101.80	5.74	6.43	8.08	9.04
4"	114.07	114.50	6.02	6.73	8.56	9.58
5"	141.05	141.55	6.55	7.34	9.52	10.67
6"	168.00	168.56	7.11	7.98	10.97	12.29
8"	218.70	219.46	8.18	9.17	12.70	14.22
10"	272.67	272.43	9.27	10.39	15.06	16.87
12"	323.47	324.23	10.31	11.56	17.45	19.52

UPVC PRESSURE PIPE
In accordance to ASTM D 2241 - 96A

Nominal pipe size (in)	Average outside diameter (in)	Wall thickness (in)					
		SDR 41 100 PSI	SDR 32.5 125 PSI	SUR 26 160 PSI	SDR 21 200 PSI	SDR 17 250 PSI	SDR 13.5 315 PSI
In	In	Mm	Mm	Mm	Mm	Mm	Mm
1/2"	0.840	-	-	-	-	-	0.062
3/4"	1.050	-	-	-	0.060	0.062	0.078
1"	1.315	-	-	0.060	0.063	0.077	0.097
1 1/4"	1.660	-	-	0.064	0.079	0.098	0.123
1 1/2"	1.900	-	-	0.073	0.090	0.112	0.141
2"	2.365	-	-	0.091	0.113	0.140	0.176
2 1/2"	2.875	-	-	0.110	0.137	0.169	0.213
3"	3.500	-	0.108	0.135	0.167	0.206	0.259
4"	4.500	0.110	0.138	0.173	0.214	0.265	0.333
6"	6.625	0.162	0.204	0.255	0.316	0.390	0.491
8"	8.625	0.210	0.265	0.332	0.410	0.508	-

UPVC PLAIN ELBOW (90°)

BS 4346 in inch

D (in)	A	B	d	PN
3/4"	33	35	16	16
1"	41	44	20	16
1 1/4"	52	49	23	16
1 1/2"	61	59	28	16
2"	77	73	34	16
2 1/2"	90	84	38	16
3"	108	97	46	16
4"	130	118	56	16

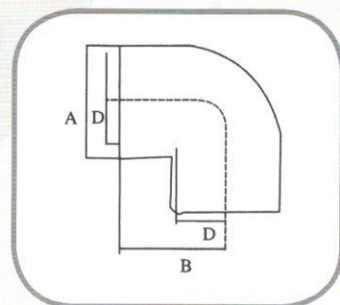
**UPVC PLAIN ELBOW (90°)**

DIN 8063 in mm

D	A	B	d	PN
20	26	30	13	16
25	33	35	16	16
32	41	44	20	16
50	61	59	28	16
63	77	73	34	16
75	89	84	38	16
90	108	97	46	16
110	130	118	56	16
160	185	234	82	16
200	232	208	103	16
225	258	234	114	16
250	286	319	128	16
315	358	401	161	16

UPVC PLAIN ELBOW (45°)

DIN 8063 in mm

d	A	B	d	PN
25	32	30	7	16
32	40	35	11	16
50	61	43	12	16
63	77	53	15	16
75	89	61	17	16
90	106	71	20	16
110	129	85	24	16
160	186	121	35	16
180	210	142	39	16
200	232	149	53	16
225	260	176	55	16
250	286	189	58	16
315	359	230	66	16

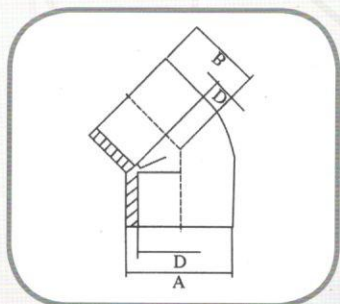

UPVC FEMALE ELBOW (90°)
ONE SIDE THREADED
BS 4346

GxD	A	B	D	D1	PN
20 x 1/2"	30	28	11	11	16
25 x 3/4"	36	33	14	14	16
32 x 1"	45	39	16	17	16
50 x 1 1/2"	61	58	27	36	16
63 x 2"	77	71	33	45	16
75 x 2 1/2"	89	83	39	53	16
90 x 3"	106	98	47	65	16
110 x 4"	129	118	57	79	16

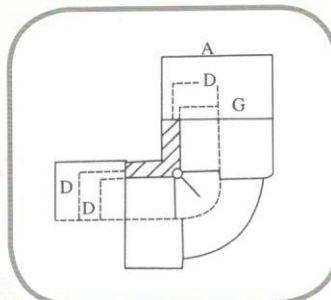

UPVC FEMALE ELBOW (90°)
TWO SIDE THREADED
BS 4346 in inch

G	L	Z	E	PN
3/8"	11.4	11.6	23.5	16
1/2"	15.0	12.0	26.5	16
3/4"	16.3	16.7	32.5	16
1"	19.1	19.9	41	16
1 1/4"	21.4	27.6	50	16
1 1/2"	21.4	37.6	60	16
2"	25.7	46.3	75	16
2 1/2"	30.2	53.8	89	16
3"	33.3	65.7	106	16
4"	39.3	79.7	129	16

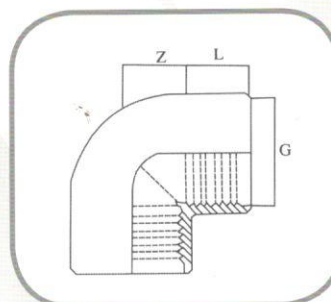

UPVC FEMALE ELBOW (45°)
TWO SIDE THREADED
BS 4346 in inch

G	L	Z	E	PN
3/8"	11.4	8.1	23.5	16
1/2"	15.0	6.5	28	16
3/4"	16.3	8.7	34	16
1"	19.1	10.9	42	16
1 1/4"	21.4	14.6	51	16
1 1/2"	21.4	21.6	61	16
2"	25.7	27.3	75	16
2 1/2"	30.2	31.8	89	16
3"	33.3	38.7	106	16
4"	39.3	46.7	128	16

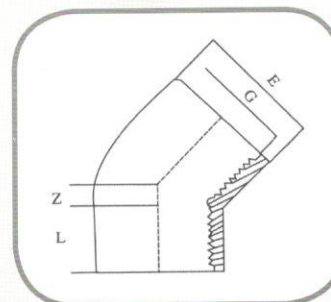

UPVC FEMALE ELBOW (45°)
ONE SIDE THREADED
DIN 8063 in inch

DxG	L	LI	Z	Z1	E	PN
16 x 3/8"	14	11.4	5.5	8.1	23.5	16
20 x 1/2"	16	15	5.5	6.5	25	16
25 x 3/4"	19	16.3	6	8.7	0.34	16
32 x 1"	22	19.1	8	10.9	42	16
40 x 1 1/2"	26	21.4	10	14.6	51	16
50 x 1 1/2"	31	21.4	12	21.6	61	16
63 x 2"	38	25.7	15	27.3	77	16
75 x 2 1/2"	44	30.2	18	31.8	87	16
90 x 3"	51	33.3	21	38.7	196	16
110 x 4"	61	39.3	25	46.7	178	16

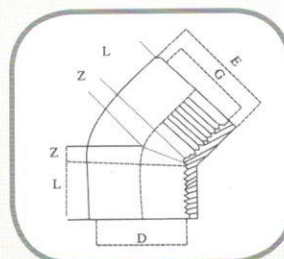

UPVC PLAIN EQUAL TEE (90°)

BS 4346 in inch

D	A	B	C	D	PN
1/2"	26	55	27	11	16
3/4"	33	69	34	13	16
1"	41	83	41	17	16
1 1/2"	61	118	59	27	16
2"	74	137	69	32	16
2 1/2"	90	165	83	38	16
3"	110	204	102	46	16
4"	130	235	118	56	16

UPVC PLAIN EQUAL TEE (90°)

DIN 8063 in mm

D	A	B	C	D	PN
20	26	55	27	11	16
25	33	69	34	13	16
32	41	83	41	17	16
50	61	118	59	27	16
63	77	143	72	33	16
75	90	165	83	38	16
90	110	204	102	46	16
110	130	235	118	56	16
160	189	340	169	83	16
225	260	470	235	116	16
250	290	552	261	130	16
315	365	655	328	164	16

UPVC REDUCING TEE (90°)

DIN 8063 in mm

D x d1	A1	B	C	D	PN
50 x 20	61	33	116	46	16
50 x 25	60	33	116	46	16
50 x 32	60	41	116	50	16
63 x 20	77	33	147	53	16
63 x 25	77	33	147	53	16
63 x 32	77	43	147	56	16
63 x 50	77	63	147	64	16
90 x 20	102	36	195	74	16
90 x 25	102	36	195	74	16
90 x 32	102	45	195	75	16
90 x 50	102	61	195	90	16
90 x 63	102	73	195	93	16
110 x 63	126	74	234	95	16
110 x 90	126	105	234	108	16
125x63	142	77	268	112	16
125x90	142	102	268	118	16
125x110	142	126	272	116	16
160x90	199	102	332	118	16
160 x 110	199	131	336	118	16
200x90	228	118			16
200x110	228	130			16
200x125	228	150			16
200x160	228	190			16
250x110	280	134			16
250x125	280	150			16
250x160	280	196			16
250x200	280	228			16
250x225	280	250			16
315x110	350	134			16
315x125	350	150			16
315x160	350	196			16
315x200	350	230			16
315x225	350	255			16
315x250	350	280			16

UPVC FEMALE TEE (90°)

BS 4346 in inch

G	L	Z	E	PN
3/8"	11.4	0.6	23.5	16
1/2"	15	2	27.5	16
3/4"	16.3	6.7	33.5	16
1"	19.1	9.9	42	16
1 1/4"	21.4	25.6	51	16
1 1/2"	21.4	35.6	61	16
2"	25.7	45.3	75	16
2 1/2"	30.2	52.8	89	16
3"	33.3	64.7	106	16
4"	39.3	76.7	129	16

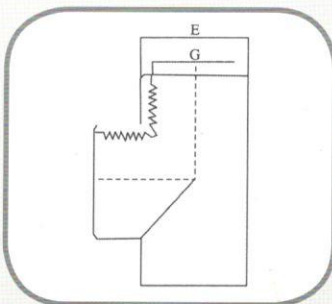
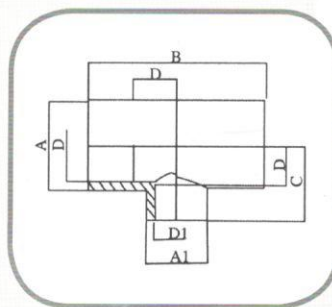
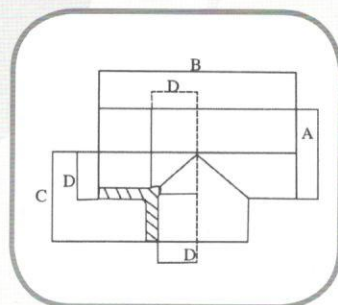

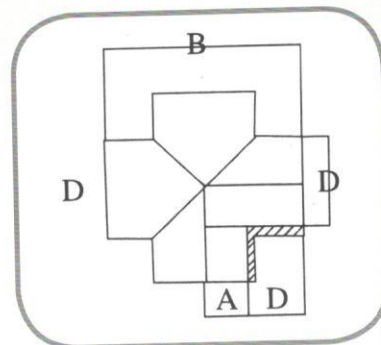

UPVC CROSS TEE
DIN 8063 in mm

D	A	B	C	D	PN
25	35	66	33	14	16
32	43	80	40	18	16
50	64	116	58	27	16
63	79	143	71.5	33.5	16
75	94	168	84	40	16
90	112	199	99.5	48.5	16
110	135	240	120	59	16
160	193	342	171	85	16

UPVC MALE ADAPTOR

BS 4346 in inch

D x G	D	C	B	D	PN
1/2	42	13	25	27	16
3/4"	44	21	26	32	16
1	58	19	29	46	16
1 1/2"	63	22	32	65	16
2"	75.5	28	38	79	16
2 1/2"	83	32	42	91	16
3"	104	35	44	110	16
4"	130	42	52	138	16



UPVC MALE ADAPTOR

BS 4346 in mm

d x G	D	C	B	D	PN
20 x 1/2"	42	15	22	27	16
25 x 3/4"	47	17	28	33	16
32 x 1"	60	18	35	46	16
50 x 1 1/2"	62	23	33	63	16
63 x 2"	75	26	37	76	16
75 x 2 1/2"	98	31	53	91	16
90 x 3"	104	36	49	108	16
110 x 4	120	39	59	127	16
160 x 6	158	52	72	185	16

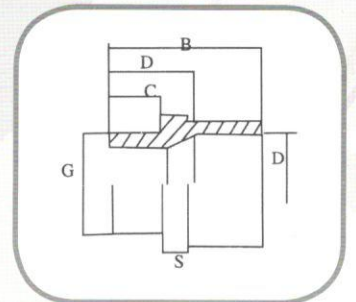

UPVC FEMALE ADAPTOR

BS 4346 in inch

D x G	D	C	B	D	PN
3/4"	40	18	2.5	36	16
1"	43	22	3	46	16
1 1/2"	60	25	4	60	16
2"	68	26	4	80	16
2 1/2"	78	32	8	90	16
3"	91	35	10	108	16
4"	119	54	21	187	16



UPVC FEMALE ADAPTOR

DIN 8063 in mm

D x G	D	C	B	D	PN
25 x 3/4"	43	18	20	36	16
32 x 1"	51	22	22	46	16
50 x 1 1/2"	62	23	30	60	16
63 x 2"	76	25	36	80	16
75 x 2 1/2"	89	30	44	91	16
90 x 3	100	33	51	108	16
110 x 4"	116	39	61	127	16

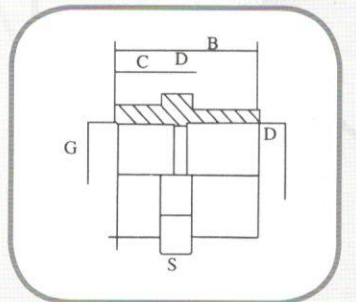

UPVC MALE/FEMALE THREADED ENDS REDUCER BS 4346 in inch

G1 x G2	S	A	C1	C2	B	PN
3/8" x 1/2"	30	28	16.3	15	41	16
1" x 1/2"	36	28	19	15	44	16
1" x 3/4"	36	34	19	16.3	46.3	16
1 1/2" x 1/4"	50	34	21.4	16.3	50.3	16
1 1/2" x 1"	50	42	21.4	19	53	16
2" x 1"	65	42	25.7	19	56	16
2" x 1 1/2"	65	58	25.7	21.4	58.4	16
3" x 1 1/2"	95	58	33.3	21.4	68.4	16
3" x 2"	95	72	33.3	25.7	72.7	16
4" x 2"	120	72	39.3	25.7	78.7	16
4" x 3"	120	103	39.3	33.3	86.3	16

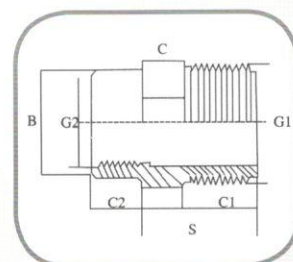

UPVC NIPPLE BS 4346 in inch

G	B	C	S	PN
3/4"	44	16.2	30	16
1"	50	19.2	36	16
1 1/2"	58	21.3	50	16
2"	66	25.7	65	16
2 1/2"	78	30.4	80	16
3"	86	33.4	95	16
4"	97	39.5	120	16

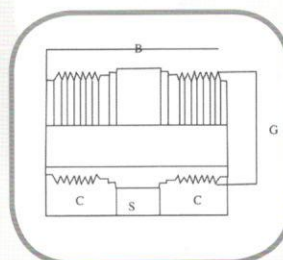

UPVC REDUCING NIPPLE BS 4346 in inch

G1 x G2	B	C1	C2	S	PN
3/4" x 1/2"	43	16.3	15	30	16
1 x 3/4"	47	19	16.3	36	16
2" x 1 1/2"	62	25.7	21.4	65	16
2 1/2" x 2"	72	30.2	25.7	80	16
3" x 2 1/2"	82	33.3	30.2	95	16
4" x 3"	90	39.3	33.3	120	16

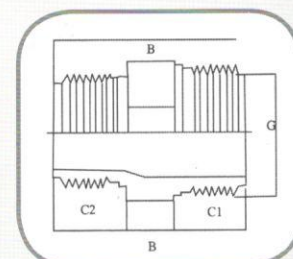

UPVC END CAP

BS 4346 in inch

d	A	B	C	PN
3/4"	33	26	19	16
1"	41	30	22	16
1 1/2"	62	40	31	16
2"	47	46	38	16
3"	104	64	54	16
4"	125	67	59	16

UPVC END CAP

DIN 8063 in mm

d	A	B	C	PN
25	32	25	19	16
32	41	28	22	16
50	60	38	31	16
63	77	47	38	16
75	90	51	42	16
90	104	64	54	16
110	125	67	59	16
160	175	110	82	16
200	227	145	98	16
225	254	160	113	16
250	290	175	160	16
315	354	165	280	16
400	440	330	310	16

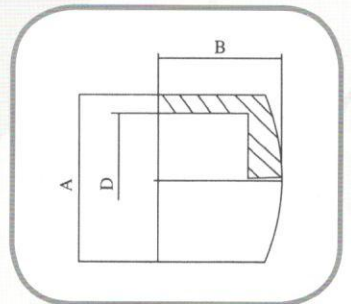

UPVC FEMALE THREADED END CAP

BS 4346 in inch

G	A	B	C	PN
3/4"	33	25	18	16
1"	41	29	21	16
1 1/2"	59	39	30	16
2"	76	37	27	16
2 1/2"	89	50	31	16
3"	104	63	35	16
4"	128	67	40	16
6"	190	108	55	16

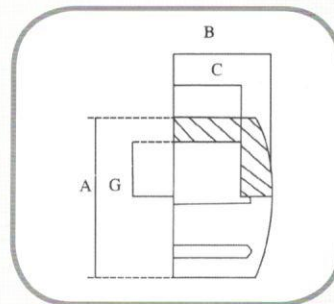

UPVC MALE THREADED END CAP

BS 4346 in inch

G	L	H	C	PN
3/8"	11.4	23	9	16
1/2"	15	29	24	16
3/4"	16.3	30	33	16
1"	19.1	33	36	16
1 1/4"	21.4	39	46	16
1 1/2"	21.4	39	56	16
2"	25.7	43	65	16
2 1/2"	30.2	53	80	16
3"	33.3	58	95	16
4"	39.3	65	120	16

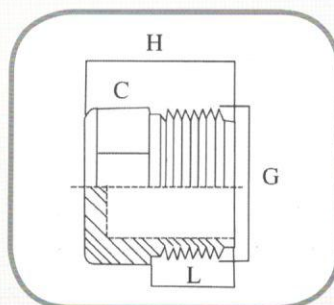

UPVC PLAIN SOCKET

BS 4346 in inch

D	A	B	D	PN
1/2"	26	37	3	16
3/4"	23	42	3	16
1"	41	48	3	16
1 1/2"	60	66	3	16
2"	73	80	3	16
2 1/2"	87	149	4	16
3"	104	119	s	16
4"	127	234	6	16
6"	182	278	10	16



UPVC PLAIN SOCKET

DIN 8063 in mm

D	A	B	D	PN
20	26	37	3	16
25	33	42	3	16
32	41	48	3	16
50	60	66	3	16
63	73	80	3	16
75	87	149	4	16
90	104	119	5	16
110	127	234	6	16
160	183	278	10	16
200	231	224	12	16
225	262	249	11	16
250	286	272	10	16
315	355	340	12	16

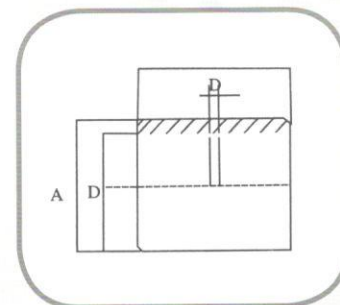

UPVC PLAIN REDUCING SOCKET

DIN 8063 in mm

d x d1	A	B	A1	D	PN
25 x 20	32	43	26	6	16
32 x 20	41	47	26	8	16
32 x 25	41	52	32	8	16
50 x 25	60	66	23	16	16
50x 32	60	66	41	14	16
63 x 50	74	82	60	13	16
75 x 63	90	97	75	15	16
90x 63	109	110	75	20	16
90x 75	109	115	90	22	16
110x90	129	118	109	17	16
160x110	183	177	129	28	16
200x110	230	230	130	30	16
200x160	230	240	190	30	16

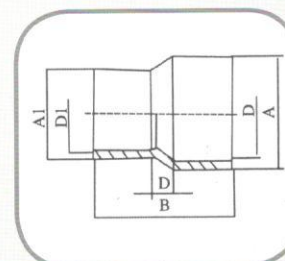

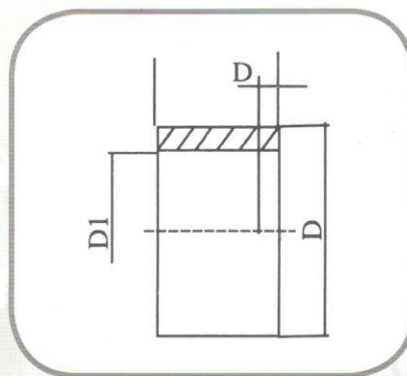

UPVC REDUCING BUSH
BS 4346 in inch

d	B	D	PN
1/2" x 3/8"	17	2.5	16
3/4" x 3/8"	20	5.5	16
3/4" x 1/2"	20	2.5	16
1" x 1/2"	22	5.5	16
1 x 3/4"	22	3	16
1 1/4" x 1/2"	26	10	16
1 1/4" x 3/4"	26	6	16
1 1/4" x 1"	26	4	16
1 1/2" x 1/2"	31	14	16
1 1/2" x 3/4"	31	12	16
1 1/2" x 1"	31	8	16
1 1/2" x 1 1/4"	31	5	16
2" x 1/2"	38	21	16
2" x 3/4"	38	18	16
2" x 1"	38	17	16
2" x 1 1/4"	38	2	16
2" x 1 1/2"	38	7	16
2 1/2" x 1 1/2"	45	14	16
2 1/2" x 2"	45	7	16
3" x 1 1/2"	52	21	16
3 x 2"	52	14	16
3" x 2 1/2"	52	8	16
4" x 2"	63	23.5	16
4" x 2 1/2"	63	17.5	16
4" x 3"	63	10	16

UPVC REDUCING BUSH
D I N 8063 in mm

d x d1	B	D	PN
20 x 16	17	2.5	16
25 x 16	20	2.5	16
25 x 20	20	2.5	16
32 x 20	22	5.5	16
32 x 25	22	3	16
40 x 20	26	10	16
40 x 25	26	6	16
40 x 32	26	4	16
50 x 20	31	14	16
50 x 25	31	12	16
50 x 32	31	8	16
50 x 40	31	5	16
63 x 20	38	21	16
63 x 25	38	18	16
63 x 32	38	17	16
63 x 40	38	12	16
63 x 50	38	7	16
75 x 50	45	14	16
75 x 63	45	7	16
90 x 50	52	21	16
90 x 63	52	14	16
90 x 75	52	8	16
110 x 63	63	23.5	16
110 x 75	63	17.5	16
110 x 90	63	10	16
160 x 90	85	36	16
160 x 110	85	26	16
200 x 160	106	30	16
225 x 160	119	33	16
225 x 200	119	13	16
250 x 160	132	45	16
250 x 200	132	25	16
250 x 225	132	12	16
315 x 200	165	58	16
315 x 225	165	45	16
315 x 250	165	33	16

UPVC UNION WITH O-RING
BS 4346 in inch

G	L	Z1	Z2	G1	E	O-RING	PN
3/8"	11.4	5.6	12.6	3/4	67	3060	16
1/2"	15	4	11	1	42	4081	16
3/4"	16.3	5.7	12.7	1 1/4	52	4112	16
1"	19.1	5.9	12.9	1 1/2	59	4131	16
1 1/4"	21.4	7.6	16.6	2	72	6162	16
1 1/2"	21.4	12.6	23.6	2 1/4	79	6187	16
2"	25.7	15.3	30.3	2 3/4	96	6237	16
2 1/2"	30.2	16.8	31.8	3 1/2	119	6321	16
3"	33.3	22.7	35.7	4	134	6362	16
4"	39.3	26.7	39.7	5	163	6450	16



UPVC UNION WITH O-RING
BS 4346 in mm

G	L	Z1	Z2	G1	E	O-RING	PN
20	15	4	11	1	42	4081	16
25	16.3	5.7	12.7	1 1/4	52	4112	16
32	19.1	5.9	12.9	1 1/2	59	4131	16
50	21.4	12.6	23.6	2 1/4	79	6187	16
63	25.7	15.3	30.3	2 3/4	96	6237	16
75	30.2	16.8	31.8	3 1/2	119	6321	16
90	33.3	22.7	35.7	4	134	6362	16
110	39.3	26.7	39.7	5	163	6450	16

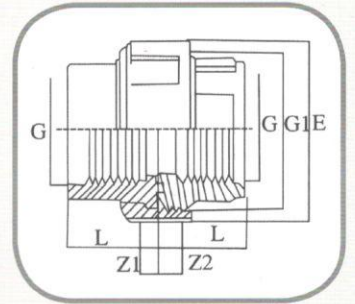

UPVC FLANGE STUB

DIN 8063 in mm

Flange Size	d1	d2	d3	d4	A	B	C	PN
90	90.3	125	108	86	51	11	5	16
110	110.4	150	130	105	61	12	5	16
125	140.5	188	165	134	76	14	5	16
160	160.5	212	188	153	86	18	5	16
200	200.5	248	232	192	106	22	7	16
250	250.5	303	275	240	131	23	9	16
280	280.6	328	306	268	146	26	9	16
315	315.8	378	342	302	164	31	10	16
400	400.8	442	445	408	230	32	26	16

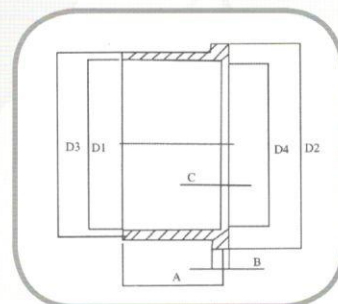

UPVC FLANGE RING

DIN 8036 in mm

Flange Ring	D5	D6	D7	D	N	H	PN
90	110	160	200	20	8	18	16
110	133	180	220	22	8	18	16
125	167	210	240	26	8	18	16
160	190	240	280	28	8	22	16
200	235	272	315	36	8	22	16
250	277	325	370	36	8	22	16
280	308	350	395	36	12	22	16
315	345	400	445	36	12	22	16
400	450	500	500	50	12-16	22	16

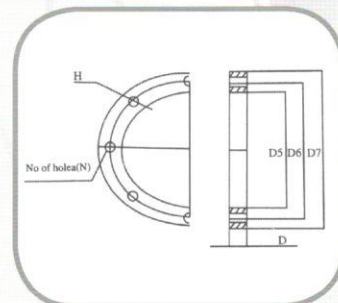

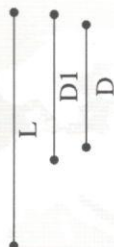

UPVC ELBOW 90° (R/R)

DIN 8063 in mm

d	d1	L	PN
110	136	338	16
160	185	329	16
225	263	279	16
250	320	380	16
315	358	410	16
355	400	396	16
400	444	443	16
450	508	493	16
500	560	543	16
550	604	594	16
630	676	690	16

**UPVC EQUAL TEE (R/R)**

DIN 8063 in mm

D.mm	D1	L	L1	PN
110	136	350	238	16
160	185	450	329	16
225	265	617	280.	16
250	300	700	320	16
315	362	800	410	16
355	400	810	396	16
400	445	886	443	16
450	508	986	493	16
500	560	1086	543	16
550	610	1186	594	16
630	680	1380	690	16

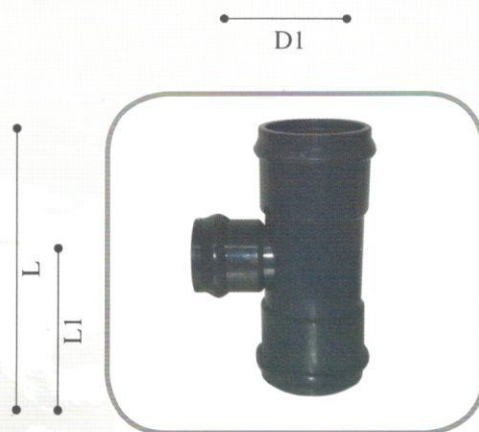

UPVC REDUCING TEE 90° (R/R)
DIN 8063 in mm

D1 x D mm	L	L1	PN
110 x 90	350	239	16
160 x 90	450	284	16
160 x 110	450	285	16
225 x 90	617	325	16
225 x 110	617	345	16
225 x 160	617	414	16
315 x 110	800	464	16
315 x 160	800	510	16
315 x 225	800	536	16
315 x 250	800	536	16
355 x 160	810	496	16
355 x 225	810	535	16
355 x 250	810	565	16
355 x 315	810	566	16
400 x 160	886	541	16
400 x 200	886	565	16
400 x 225	886	580	16
400 x 250	886	595	16
400 x 315	886	634	16
400 x 355	886	658	16
450 x 160	986	596	16
450 x 225	986	635	16

D1 x D mm	L	L1	PN
450 x 250	986	650	16
450 x 315	986	689	16
450 x 355	986	713	16
450 x 400	986	740	16
500 x 160	1086	636	16
500 x 225	1086	675	16
500 x 250	1086	690	16
500 x 315	1086	720	16
500 x 355	1086	743	16
500 x 400	1086	766	16
500 x 450	1086	791	16
550 x 225	1186	735	16
550 x 250	1186	750	16
550 x 315	1186	790	16
550 x 400	1186	816	16
550 x 450	1186	841	16
630 x 225	1130	558	16
630 x 315	1130	803	16
630 x 355	1130	863.5	16
630 x 400	1130	886	16
630 x 500	1130	936	16

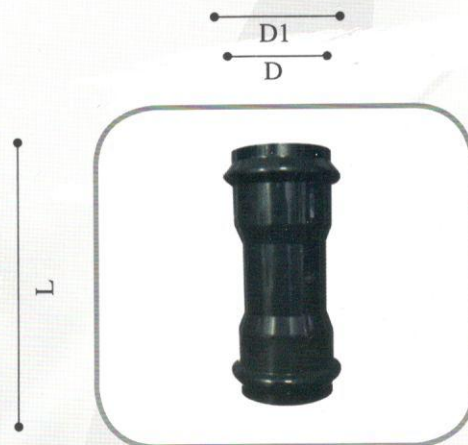
**UPVC SOCKET (R/R)**
DIN 8063 in mm

D.mm	D1	L	PN
110	136	350	16
160	186	450	16
225	365	617	16
250	320	675	16
315	362	800	16
355	400	810	16
400	445	886	16
450	508	986	16
500	560	1086	16
550	610	1186	16
630	680	1380	16

PVC BALL VALVE

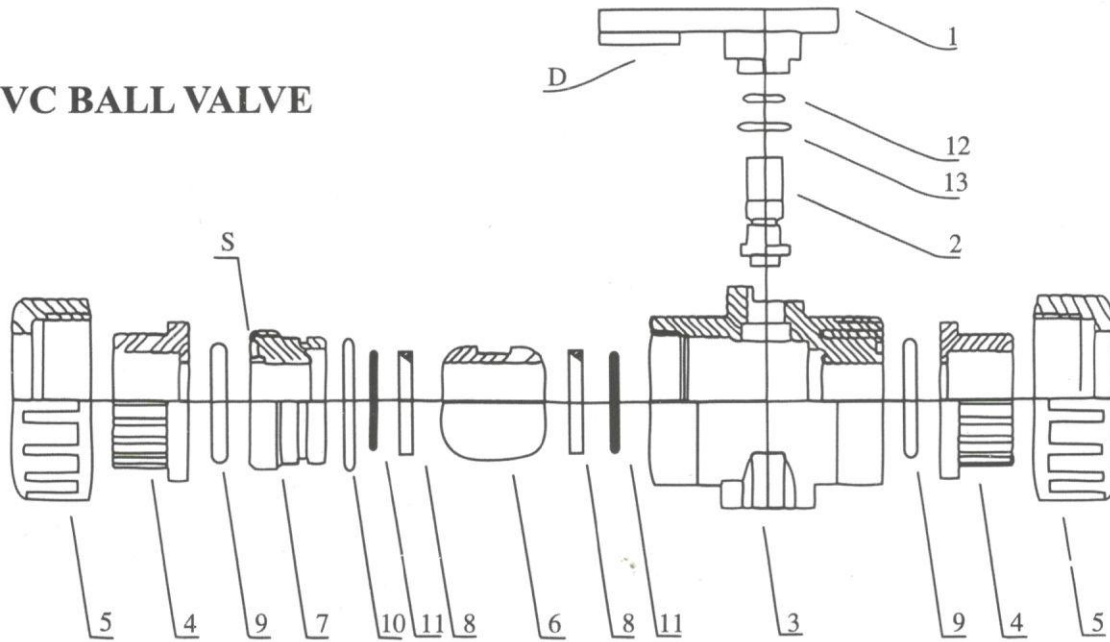

UPVC BALL VALVE

No.	Components	Material
1	Handle	PVC
2	Stem	PVC
3	Body	PVC
4	Union End	PVC
5	Union Nut	PVC
6	Ball	PVC
7	Sealing Bush	PVC
8	Ball Seat	PTEE
9	Union O-Ring	EPDM
10	O-Ring Sealing Bush	EPDM
11	O-Ring BallSeat	EPDM
12	O-Ring Stem	EPDM.
13	Stem O-Ring Inner	EPDM

UPVC BALL VALVE SOLVENT CEMENT SOCKET IN (MM)

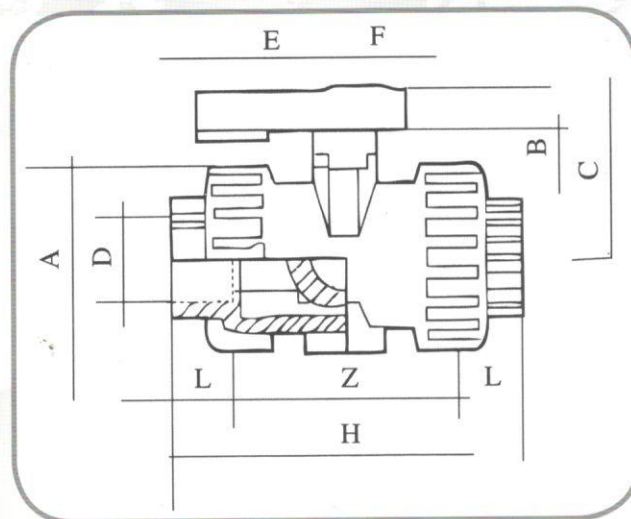

DIN 8063 in mm

d	DN	L	Z	H	A	B	C	E	F	PN
16	10	14	70	98	50	10	48	39	19	16
20	15	16	70	102	50	10	48	39	19	16
25	20	19	82	120	60	11	54	47	22	16
32	25	22	84	128	68	13	62	55	25	16
40	32	26	95	147	80	18	75	60	30	16
50	40	31	101	163	96	20	87	68	35	16
63	50	38	121	197	116	20	101	80	40	16
75	65	44	126	214	145	25	123	90	45	16
90	80	51	139	241	466	28	138	100	50	16
110	100	61	159	281	210	28	160	120	60	16

UPVC BALL VALVE SOLVENT CEMENT SOCKET IN (INCH)

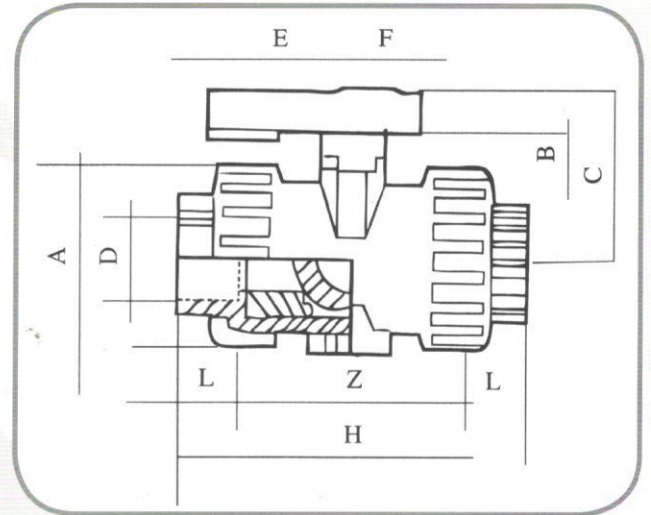
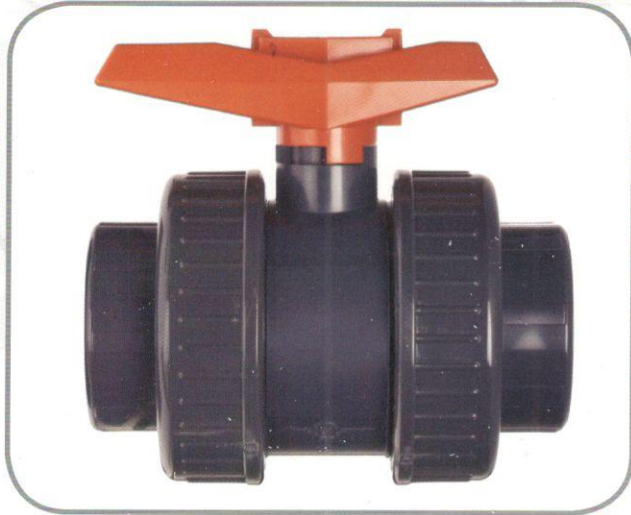

d	DN	L	Z	H	A	B	C	E	F	PN
3/8"	10	14	70	98	50	10	48	39	19	16
1/2"	15	16	70	102	50	10	48	39	19	16
3/4"	20	19	82	120	60	11	54	47	22	16
1"	25	22	84	128	68	13	62	55	25	16
1 1/4"	32	26	95	147	80	18	75	60	30	16
1 1/2"	40	31	101	163	96	20	87	68	35	16
2"	50	38	121	197	116	20	101	80	40	16
2 1/2"	65	44	126	214	145	25	123	90	45	16
3"	80	51	139	241	166	28	138	100	50	16
4"	100	61	159	281	210	28	160	120	60	16

UPVC BALL VALVE SOLVENT CEMENT SOCKET IN (MM & INCH)

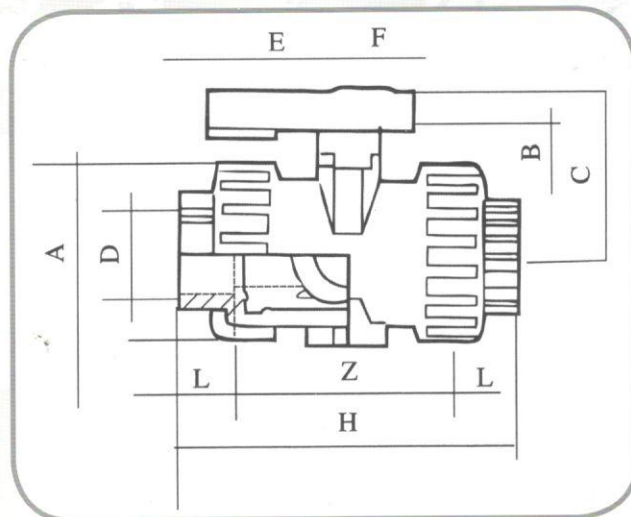

D	DN	L	Z	H	A	B	C	E	F	PN
16 x 3/8"	10	14	70	98	50	10	48	39	19	16
20 x 1/2"	15	16	70	102	50	10	48	39	19	16
25 x 3/4"	20	19	82	120	60	11	54	47	22	16
32 x 1"	25	22	M	128	68	13	62	55	25	16
40 x 1 1/2"	32	26	95	147	80	18	75	60	30	156
50 x 1 1/2"	40	31	101	163	96	20	87	68	35	16
63 x 2"	50	38	121	197	116	20	101	80	40	16
75 x 2 1/2"	65	44	126	214	145	25	123	90	45	16
90 x 3"	80	51	139	241	466	28	138	100	50	16
110 x 4"	100	61	159	281	210	28	160	120	60	16

UPVC BALL VALVE FEMALE THREADED IN (INCH)

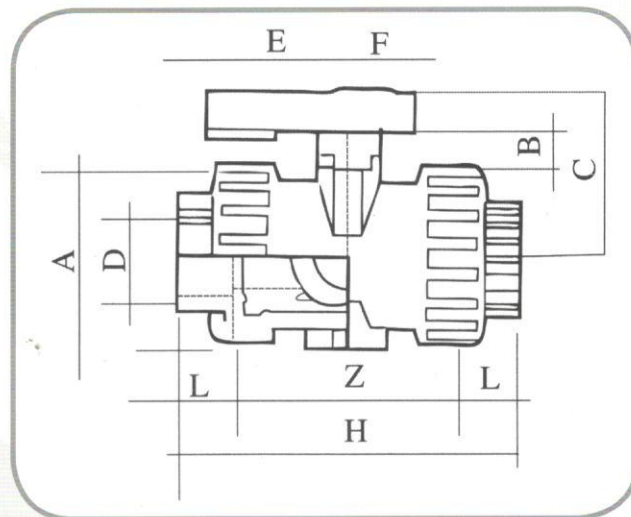

D	DN	L	Z	H	A	B	C	E	F	PN
3/8"	10	14	70	98	50	10	48	39	19	16
1/2"	15	16	70	102	50	10	48	39	19	16
3/4"	20	19	82	120	60	11	54	47	22	16
1"	25	22	84	128	68	13	62	55	25	16
1 1/4"	32	26	95	147	80	18	75	60	30	16
1 1/2"	40	31	101	163	96	20	87	68	35	16
2"	50	38	121	197	116	20	101	80	40	16
2 1/2"	65	44	126	214	145	25	123	90	45	16
3"	80	51	139	241	166	28	138	100	50	16
4"	100	61	159	281	210	28	160	120	60	16

UPVC DOUBLE SOCKETS (R/R)

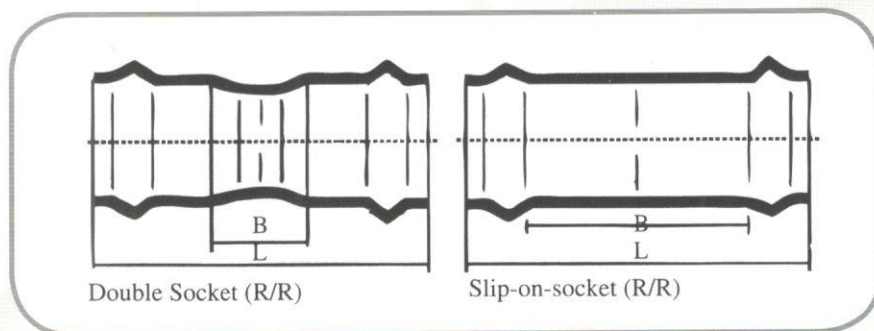

Outside diameter of pipe (D)	S/W Coupler		DS (R/R)		SOS (R/R)	
	L	B	L	B	L	B
20 mm	100	35	-	-	-	-
25	100	40	-	-	-	-
32	100	45	-	-	-	-
40	120	50	-	-	-	-
50	150	60	-	-	-	-
63	190	70	230	30	-	-
75	200	70	240	32	-	-
90	220	80	290	72	-	-
110	250	80	320	90	270	155
140	290	85	330	80	-	-
160	340	118	335	71	330	190
200	400	140	400	120	-	-
225	485	180	410	106	405	235
280	580	220	475	135	470	290
315	670	270	570	210	540	360

PROPERTIES OF UPVC PIPES

Since uPVC is a thermo-plastic material, its physical properties vary as temperature changes, when used at high temperatures. uPVC pipes cannot be used for hot water over 60°C.

Pressure Rating:

The nominal working pressures are calculated to give continuous use for over 50 years service life. The operating pressure are for temperatures at 20°C, as temperature increases the pressure rating of the pipe decreases and an appropriate de-rating factor should be applied as follows:

Working Temperatures		De-rating Multiplier
° C	° F	
23	73	1
27	80	0.88
32	90	0.75
38	100	0.62
43	110	0.51

Some properties of UPVC Pipes (Unplasticized Polyvinyl Chloride):

Property	Value
Specific Gravity	1.43
Rockwell Hardness R (Degree)	110-120
Tensile Strength (Kg/cm ²)	450-550
Elongation (%)	80-150
Compression Strength (Kg/cm ²)	700
Shear Strength (Kg/cm ²)	450
Bending Strength (Kg/cm ²)	1000
Tensile Modulus (10 ⁴ Kg/cm ²)	5-7
Impact Strength (Kg — cm / cm ²)	2.5-3.5
Resistance To Heat (°C)	60-70
Brittle Temperature (°C)	-18
Vicat Softening Temperature (°C)	80
Linear Thermal Expansion (10 ⁻⁷ ° C)	6-8
Specific Heat (Cal/°C/g)	0.2-2.3
Thermal Conductivity (Kcal/ rn-h — °C)	0.12-0.14

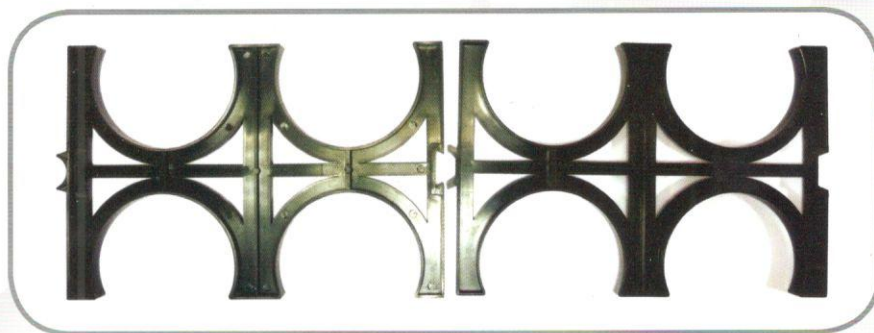

PIPE SPACER in mm

50 × 50 mm
110 × 50 mm
110 × 110 mm

DRAINAGE DUCT 1 M

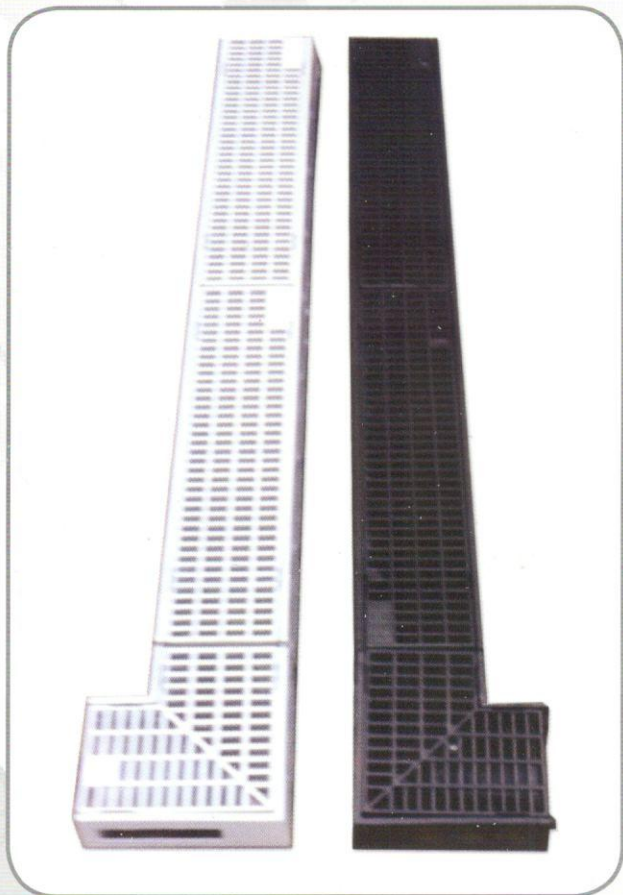

ELBOW

ZIRCU Plastic Industries

GULLY TRAP

Kind	Dimention (L - W- H)	Weight	Entry and exit holes
20 - Z	20×20×20 cm	900 g	50 - 63 - 75 - 90 - 110mm
30 - Z	30×30×30 cm	2730 g	50 - 63 - 75 - 110 - 125 - 160mm
40 - Z	40×40×40 cm	6650 g	50 - 63 - 75 - 110 - 125 - 160 - 200 - 225mm
60 - Z	60×60×60 cm	12500 g	50 - 63 - 75 - 110 - 125 - 160 - 200 - 225 - 250 - 315mm
80 - Z	80×80×(60-120) cm	14500 g	50 - 63 - 75 - 110 - 125 - 160 - 200 - 225 - 250 - 315mm





PLASTIC INDUSTRIES

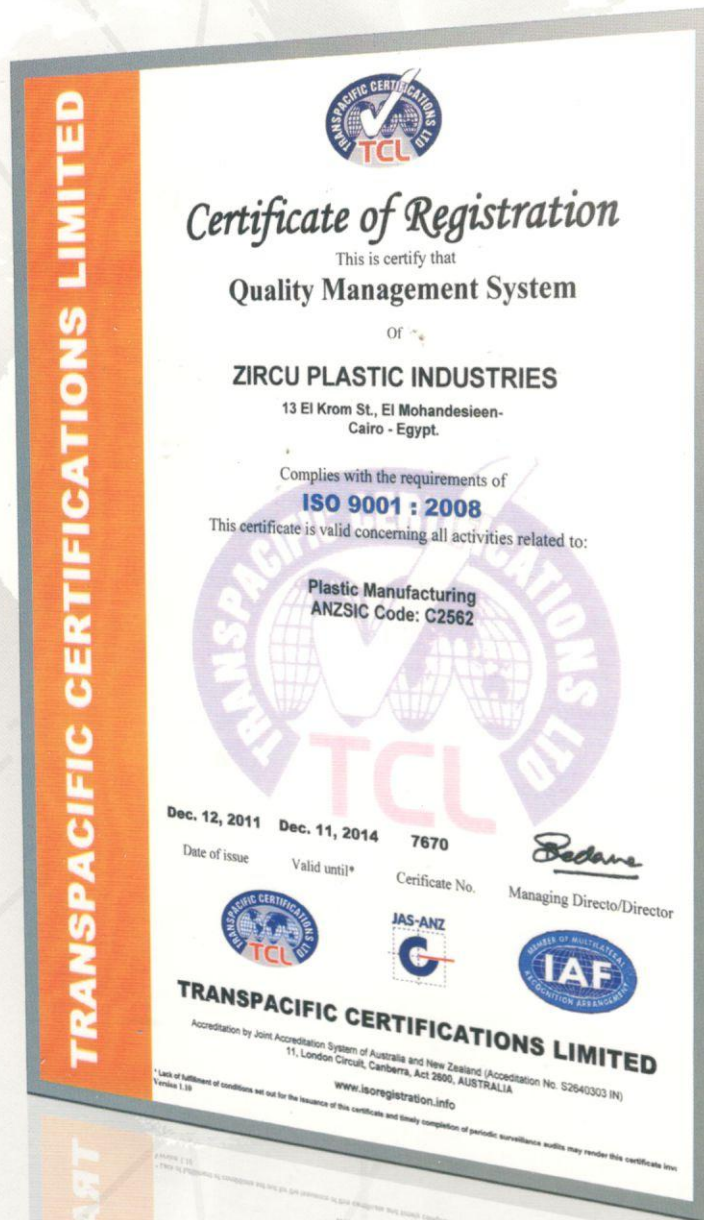

أول مصنع فى العالم لإنتاج الوصلات حتى مقاس 630 مم للضغط العالى

Z I R C U P L A S T I C I N D U S T R I E S

www.zircuegypt.com



ZIRCU

Plastic Industries



039



ISO 9001 : 2000

الإدارة : 13 شارع الكروم - خلف مسجد مصطفى محمود - المهندسين - الجيزة
 تليفون : (+202) 33389404 - (+202) 37622905 - فاكس : (+202) 37624462
 المصانع : مدينة النوبارية الصناعية - طريق مصر إسكندرية الصحراوي كيلو 130
 تليفون : 2633045 - 2634128 - 2633301 (+2045) فاكس : 2633045 (+2045)

Website: www.zircuegypt.com

E-mail: zircu@zircuegypt.com

E-mail: zircu_co@hotmail.com